

# Thordon knows Rudder and Steering Gear Bearings!

With over 40,000 vessel years of experience over the past 40 years, a Thordon solution has been developed for the live end of a hydraulic steering system. The ThorPlas-Blue Self-Aligning Bearing (SAB) solves the problem of less than desirable alignment tolerances in the hydraulic steering system design.

As most bearings in the steering system are greased sleeve type bushings, there is no allowance for vertical movement of the tiller pins. The ThorPlas-Blue SAB allows the bearing to tolerate small angular misalignment resulting from deflection or improper mounting.

However, misalignment is not the only stress input on this type of product: vibration, corrosion, and pollution are also very damaging factors to the steering system. The ThorPlas-Blue SAB can handle them all!

## **Benefits:**

- Operates without grease
- Installation & bearing exchange is quick & easy
- Rudders operate without any binding
- Reduces piston and cylinder damage
- Operate under high loads of pressures to 6,527 psi
- Eliminates grease on deck and oily run off into waterways



## **About ThorPlas-Blue**

ThorPlas-Blue is a homogeneous, self-lubricating polymer material with low dry coefficient of friction, high strength and low creep. ThorPlas-Blue bearings are tough and reliable and fit into virtually all applications where greased bronze is used.

## ThorPlas-Blue Self-Aligning Bearing

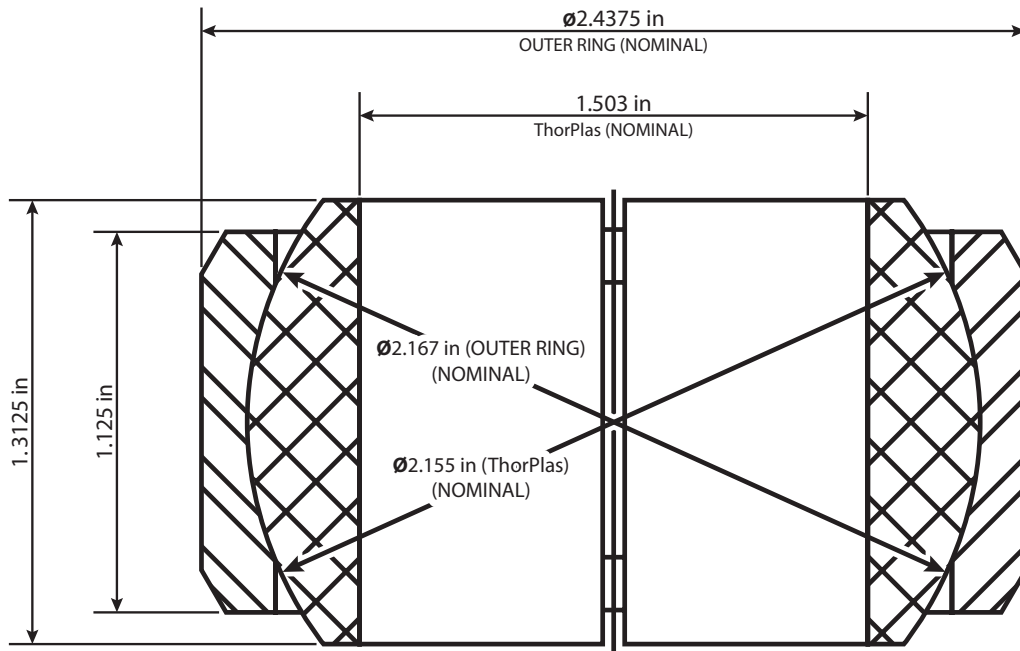

The ThorPlas-Blue SAB and hard coating pin system can be ordered in 4 standard pin sizes: 1.5", 2", 2.5", and 3", as well as in custom sizes.

### 4 STANDARD PIN SIZES:

**SHAFT DIA.: = 1.500 +0/-0.002 inches**

HOUSING DIA.: = 2.4363 +0/-0.0012 inches

MAX DESIGN TEMP.: = 158°F

MAX OPERATING LOAD: = 10,300 lbf

MAX STATIC LOAD: = 14,900 lbf

**SHAFT DIA.: = 2.000 +0/-0.002 inches**

HOUSING DIA.: = 3.1860 +0/-0.0014 inches

MAX DESIGN TEMP.: = 158°F

MAX OPERATING LOAD: = 20,200 lbf

MAX STATIC LOAD: = 29,300 lbf

**SHAFT DIA.: = 2.500 +0/-0.002 inches**

HOUSING DIA.: = 3.9359 +0/-0.0014 inches

MAX DESIGN TEMP.: 158°F

MAX OPERATING LOAD: = 33,400 lbf

MAX STATIC LOAD: = 48,500 lbf

**SHAFT DIA.: = 3.000 +0/-0.002 inches**

HOUSING DIA.: = 4.7481 +0/-0.0016 inches

MAX DESIGN TEMP.: = 158°F

MAX OPERATING LOAD: = 49,900 lbf

MAX STATIC LOAD: = 72,300 lbf

*Thordon Bearings Inc. designs and manufactures a comprehensive range of environmentally friendly bearings for marine, hydro, pump, and industrial applications. Recognized internationally for superior performance, Thordon Bearings has a worldwide customer service network in over 100 countries.*